

Quick-release claw female thread



BSPP female thread

G 1/4

Max operating pressure

10 bar

Temperature

-5°C to +60°C

Construction

Brass body

Description

Reference	BSPP female thread
EXP F813	G 1/4
EXP F1217	G 3/8
EXP F1521	G 1/2
EXP F2027	G 3/4
EXP F2634	G 1
EXP F3342	G 1 1/4

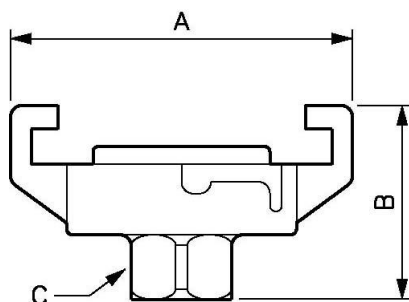

Dimensions

Reference	A mm	B mm	C mm
EXP F813	57	32	17
EXP F1217	57	32	21
EXP F1521	57	32	26
EXP F2027	57	35	33
EXP F2634	57	38	38
EXP F3342	57	43	46