

Male thread swivel coupler



BSP male thread

G 1/2

Technology

"One push" safety system
(avoids hose whip)

Operating pressure

2 to 12 bar

Flow rate at 6 bar

833 l/min ($\Delta P = 0,6$ bar)

ID Passage

6 mm

Temperature

-15°C to +70°C

Construction

Composite body

Highlight

Anti-static Non scratch

Description

Reference

BSP male thread

CSI 061153SE

G 1/2

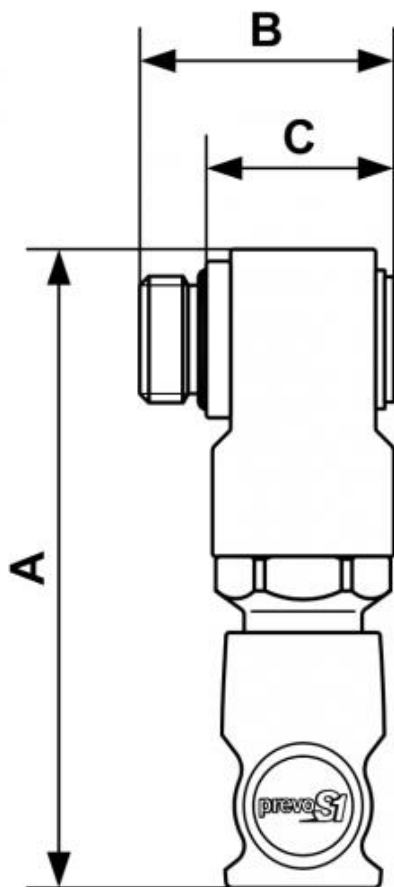

Dimensions

Reference	A mm	B mm	C mm
CSI 061153SE	104	41	29