

Parallel female thread coupler



BSPF female thread

G 1/2

NPT female thread

-

Technology

"One push" safety system
(avoids hose whip)

Operating pressure

2 to 12 bar

Flow rate at 6 bar

2028 l/min ($\Delta P = 0,6$ bar)

ID Passage

8 mm

Temperature

-15°C to +70°C

Construction

Composite body

Highlight

Anti-static Non scratch

Description

Reference	BSPF female thread	NPT female thread
USI 081103	G 1/2	-
USI 081102	G 3/8	-
USI 081101	G 1/4	-

Reference	BSPF female thread	NPT female thread
USI 081201		1/4" FNPT
USI 081202		3/8" FNPT
USI 081203		1/2" FNPT

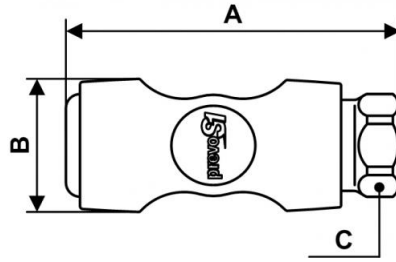

Dimensions

Reference	A mm	B mm	C mm
USI 081103	91.4	33	23
USI 081102	82.4	33	23
USI 081101	82.4	33	23
USI 081201	82.4	33	23
USI 081202	82.4	33	23
USI 081203	91.4	33	23