

## Adaptor for PA/PU semi-rigid tubing



Diameter (mm)

6 x 4

ID Passage

6 mm

Construction

Stainless steel

### Description

Reference	Diameter (mm)
<b>CRP 066804RB</b>	6 x 4
<b>CRP 066806RB</b>	8 x 6
<b>CRP 066808RB</b>	10 x 8

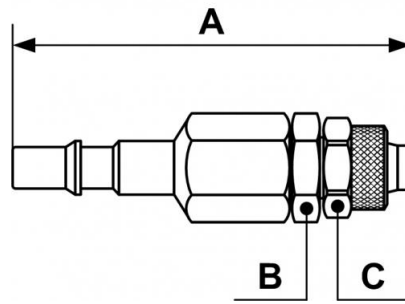

### Dimensions

Reference	A mm	B mm	C mm
<b>CRP 066804RB</b>	71	17	12
<b>CRP 066806RB</b>	71	17	14
<b>CRP 066808RB</b>	71	17	16