

# Naked mounting deck for prevoS1 wall fittings, ALTO air treatment units and accessories

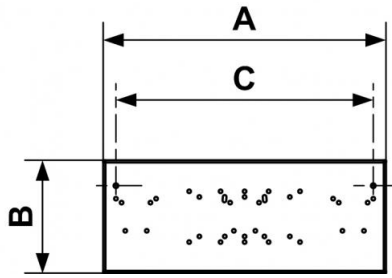

<p><b>Description</b></p> <p>Mounting deck for fastening:</p> <ul style="list-style-type: none"> <li>- prevoS1 wall brackets -</li> <li>ALTO air treatment units -</li> <li>Accessories</li> </ul> <p><b>Highlight</b></p> <p>Workstation ergonomics</p>	<p><b>Weight (max. kg)</b></p> <p>100</p>	<p><b>Construction</b></p> <p>Galvanized steel, Polyester paint</p>	<p><b>Applications</b></p> <p>Fastening system for IPN/HEA beams</p>
--	---	---	--

Description		
Reference	Description	Weight (max. kg)
<p><b>PLA 1000N</b></p>	<p>Mounting deck for fastening: - prevoS1 wall brackets - ALTO air treatment units - Accessories</p>	<p>100</p>



### Dimensions

Reference	A mm	B mm	C mm
<b>PLA 1000N</b>	500	200	455