

## Tapered male thread 90° elbow - RPC MR



**Quantity**

5

**BSPT male thread**

R 1/8

**For tube OD (mm)**

4

**Operating pressure**

0 to 10 bar

**Construction**

Polymer and nickel-plated brass

### Description

Reference	Quantity	BSPT male thread	For tube OD (mm)
<b>RPC MR0400P</b>	5	R 1/8	4
<b>RPC MR0401P</b>	5	R 1/4	4
<b>RPC MR0600P</b>	5	R 1/8	6
<b>RPC MR0601P</b>	5	R 1/4	6
<b>RPC MR0800P</b>	5	R 1/8	8
<b>RPC MR0801P</b>	5	R 1/4	8
<b>RPC MR0802P</b>	5	R 3/8	8
<b>RPC MR1001P</b>	5	R 1/4	10
<b>RPC MR1002P</b>	5	R 3/8	10

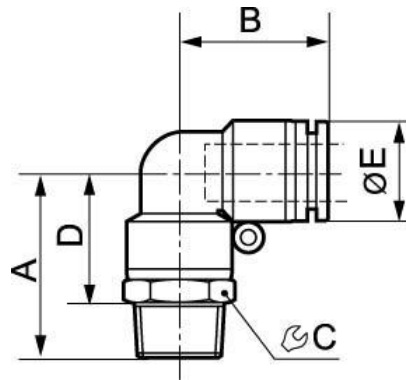

### Dimensions

#### Reference

- RPC MR0400P
- RPC MR0401P
- RPC MR0600P
- RPC MR0601P
- RPC MR0800P
- RPC MR0801P
- RPC MR0802P
- RPC MR1001P
- RPC MR1002P