

Straight union for tubes - RPU ET



Quantity

5

For tube OD (mm)

4

Operating pressure

0 to 10 bar

Temperature

0°C to + 60°C

Construction

Polymer and nickel-plated
brass

Description

Reference	Quantity	For tube OD (mm)
RPU ET0404P	5	4
RPU ET0606P	5	6
RPU ET0808P	5	8
RPU ET1010P	5	10

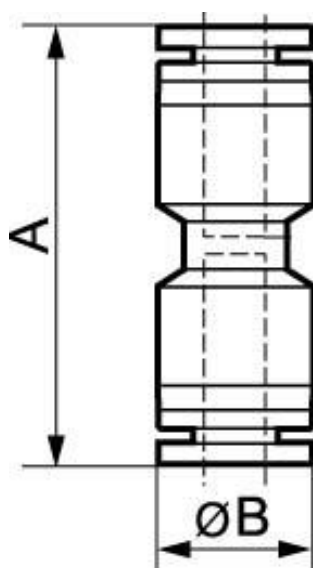

Dimensions

Reference

RPU ET0404P

RPU ET0606P

RPU ET0808P

RPU ET1010P