

## Interchangeable hydraulic coupler with valve lock mechanism

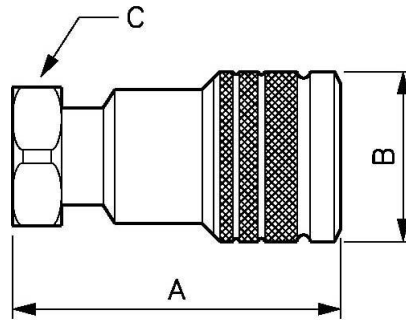

<u><b>BSPF female thread</b></u> G 1/4	<u><b>Nominal Ø (mm)</b></u> 6	<u><b>Flow rate (nominal in l/min)</b></u> 12	<u><b>Max operating pressure (bar)</b></u> 400
<u><b>Profile</b></u> Interchangeable	<u><b>Technology</b></u> Ball lock	<u><b>Temperature</b></u> -25°C to +100°C	<u><b>Construction</b></u> Body: steel
<u><b>Applications</b></u> Industry, Agricultural	<u><b>Connection</b></u> Semi-automatic		

Description				
Reference	BSPF female thread	Nominal Ø (mm)	Flow rate (nominal in l/min)	Max operating pressure (bar)
<b>HCG 061101</b>	G 1/4	6	12	400
<b>HCG 101102</b>	G 3/8	10	23	350
<b>HCG 201104</b>	G 3/4	20	106	250



### Dimensions

Reference	A mm	B mm	C mm
<b>HCG 061101</b>	55.5	27	19
<b>HCG 101102</b>	63	34	24
<b>HCG 201104</b>	86	47	34