

Hydraulic adaptor with flat ends



<u>BSPF female thread</u> G 1/4	<u>Nominal Ø (mm)</u> 6	<u>Flow rate (nominal in l/min)</u> 12	<u>Max operating pressure (bar)</u> 300
<u>Profile</u> ISO F	<u>Technology</u> Ball lock	<u>Temperature</u> -25°C to +100°C	<u>Construction</u> Body: steel
<u>Applications</u> Industry	<u>Connection</u> Automatic		

Description				
Reference	BSPF female thread	Nominal Ø (mm)	Flow rate (nominal in l/min)	Max operating pressure (bar)
HFP 066101	G 1/4	6	12	300
HFP 136102	G 3/8	13	23	250
HFP 136103	G 1/2	13	23	250

Reference	BSPP female thread	Nominal Ø (mm)	Flow rate (nominal in l/min)	Max operating pressure (bar)
HFP 206103	G 1/2	20	45	250
HFP 206104	G 3/4	20	45	250
HFP 256104	G 3/4	25	100	250
HFP 256105	G 1	25	100	250

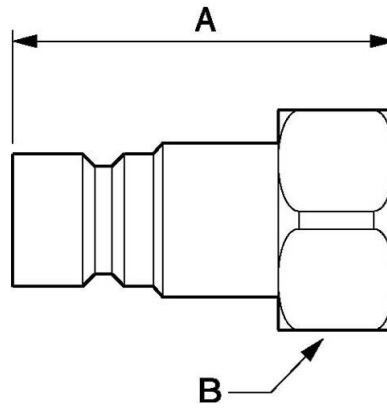

Dimensions

Reference	A mm	B mm
HFP 066101	53.5	22
HFP 136102	63.5	27
HFP 136103	67.5	27
HFP 206103	76	32
HFP 206104	72	36
HFP 256104	82	46
HFP 256105	84.5	46