

Valve adaptor for agricultural machinery

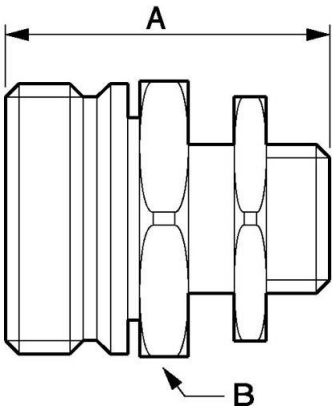

<u>Female thread</u> M18 x 1.5	<u>Nominal Ø (mm)</u> 13	<u>Flow rate (nominal in l/min)</u> 24	<u>Max operating pressure (bar)</u> 200
<u>Profile</u> Interchangeable	<u>Technology</u> Screw lock	<u>Temperature</u> -25°C to +100°C	<u>Construction</u> Body: steel
<u>Applications</u> Agricultural	<u>Highlight</u> Pressurised connection	<u>Connection</u> Manual screw thread	

Description				
Reference	Female thread	Nominal Ø (mm)	Flow rate (nominal in l/min)	Max operating pressure (bar)
HVV 136181	M18 x 1.5	13	24	200



Dimensions		
Reference	A mm	B mm
HVV 136181	49	36