

Female thread double wall bracket - Outlet 2 couplers and drain



Inlet BSPP female thread

G 1/2

Outlet BSPP female thread

G 1/2

Operating pressure

0 to 16 bar

Temperature

-20°C to +80°C

Construction

Aluminium alloy

Equipped with

Manual drain

Description

Reference	Inlet BSPP female thread	Outlet BSPP female thread
MF 103S2	G 1/2	G 1/2
MF 104S2	G 3/4	G 1/2

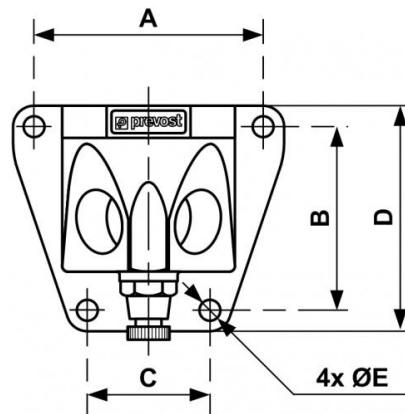

Dimensions

Reference	A mm	B mm	C mm	D mm	E mm
MF 103S2	71	57	38	70	6.5
MF 104S2	71	57	38	70	6.5