

# PPS1 9CM - 90°aluminium tapered male thread elbow fitting for pipe



<p><b><u>For pipe OD (mm)</u></b> 16</p>	<p><b><u>BSPT male thread</u></b> R 3/8</p>	<p><b><u>Technology</u></b> PPS Grip Concept</p>	<p><b><u>Operating pressure</u></b> 0 to 16 bar</p>
<p><b><u>Vacuum capability</u></b> -0.98 bar (vacuum 98%)</p>	<p><b><u>Temperature</u></b> -20°C to +80°C</p>	<p><b><u>Construction</u></b> Pipe and fittings: alu.</p>	<p><b><u>Highlight</u></b> Scalable system</p>
<p><b><u>Meets standards</u></b> PED REACH</p>			

Description		
Reference	For pipe OD (mm)	BSPT male thread
PPS1 9CM1617	16	R 3/8
PPS1 9CM1612	16	R 1/2
PPS1 9CM2012	20	R 1/2
PPS1 9CM2512	25	R 1/2

Reference	For pipe OD (mm)	BSPT male thread
PPS1 9CM2527	25	R 3/4
PPS1 9CM3234	32	R 1
PPS1 9CM4042	40	R 1 1/4
PPS1 9CM4049	40	R 1 1/2

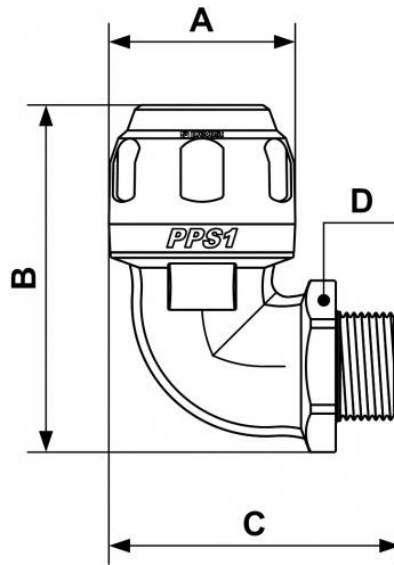

### Dimensions

Reference	A mm	B mm	C mm	D mm
PPS1 9CM1617	32	60	50	26
PPS1 9CM1612	32	60	55	26
PPS1 9CM2012	38	72	61	32
PPS1 9CM2512	46	87	72	38
PPS1 9CM2527	46	87	71	38
PPS1 9CM3234	57	103	88	46
PPS1 9CM4042	68	123	106	57
PPS1 9CM4049	68	123	106	57