

PPS1 BP - Aluminium tapping flange for pipe



| | | | |
|---|---|---|---|
| <u>For pipe OD (mm)</u> (1) 16 | <u>Technology</u> PPS Grip Concept | <u>Operating pressure</u> 0 to 16 bar | <u>Vacuum capability</u> -0.98 bar (vacuum 98%) |
| <u>Temperature</u> -20°C to +80°C | <u>Construction</u> Pipe and fittings: alu. | <u>Highlight</u> Scalable system | <u>Meets standards</u> PED REACH |

| Description | |
|-------------|------------------|
| Reference | For pipe OD (mm) |
| PPS1 BP2516 | (1) 16 |
| PPS1 BP2520 | (1) 20 |
| PPS1 BP3216 | (1) 16 |
| PPS1 BP3220 | (1) 20 |
| PPS1 BP4016 | (1) 16 |
| PPS1 BP4020 | (1) 20 |
| PPS1 BP4025 | (1) 25 |
| PPS1 BP5016 | (1) 16 |
| PPS1 BP5020 | (1) 20 |
| PPS1 BP5025 | (1) 25 |

| Reference | For pipe OD (mm) |
|---------------------|------------------|
| PPS1 BP6320 | (1) 20 |
| PPS1 BP6325 | (1) 25 |
| PPS1 BP6332 | (1) 32 |
| PPS1 BP8020 | (1) 20 |
| PPS1 BP8025 | (1) 25 |
| PPS1 BP8032 | (2) 32 |
| PPS1 BP10025 | (2) 25 |
| PPS1 BP10032 | (2) 32 |

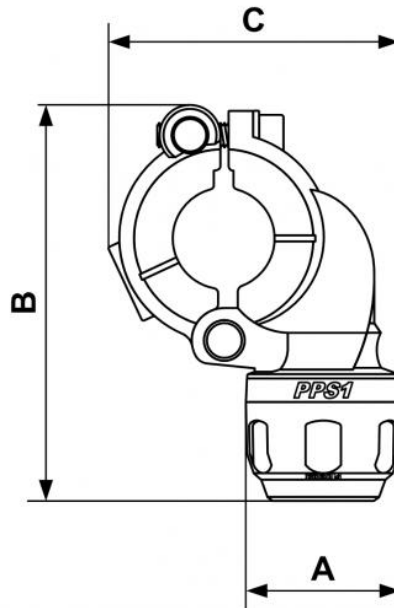

Dimensions

| Reference | A mm | B mm | C mm |
|-------------|------|------|------|
| PPS1 BP2516 | 32 | 94 | 70 |
| PPS1 BP2520 | 38 | 98 | 72 |
| PPS1 BP3216 | 32 | 94 | 70 |
| PPS1 BP3220 | 38 | 98 | 72 |
| PPS1 BP4016 | 32 | 122 | 102 |
| PPS1 BP4020 | 38 | 127 | 102 |
| PPS1 BP4025 | 46 | 130 | 103 |
| PPS1 BP5016 | 32 | 122 | 102 |
| PPS1 BP5020 | 38 | 127 | 102 |
| PPS1 BP5025 | 46 | 130 | 103 |
| PPS1 BP6320 | 38 | 163 | 147 |
| PPS1 BP6325 | 46 | 167 | 147 |

| Reference | A mm | B mm | C mm |
|--------------|------|------|------|
| PPS1 BP6332 | 57 | 165 | 147 |
| PPS1 BP8020 | 38 | 163 | 147 |
| PPS1 BP8025 | 46 | 167 | 147 |
| PPS1 BP8032 | 57 | 165 | 147 |
| PPS1 BP10025 | 200 | 159 | |
| PPS1 BP10032 | 215 | 159 | |