

## PPS - Aluminium blue bended link pipe



<p><b><u>Pipe OD (mm)</u></b></p> <p>16</p>	<p><b><u>Technology</u></b></p> <p>PPS Grip Concept</p>	<p><b><u>Operating pressure</u></b></p> <p>0 to 16 bar</p>	<p><b><u>Vacuum capability</u></b></p> <p>-0.98 bar (vacuum 98%)</p>
<p><b><u>Temperature</u></b></p> <p>-20°C to +80°C</p>	<p><b><u>Construction</u></b></p> <p>Pipe and fittings: alu.</p>	<p><b><u>Highlight</u></b></p> <p>Scalable system</p>	<p><b><u>Meets standards</u></b></p> <p>PED REACH</p>

Description	
Reference	Pipe OD (mm)
PPS LMCB16	16
PPS LMCB20	20

Reference	Pipe OD (mm)
PPS LMCB25	25

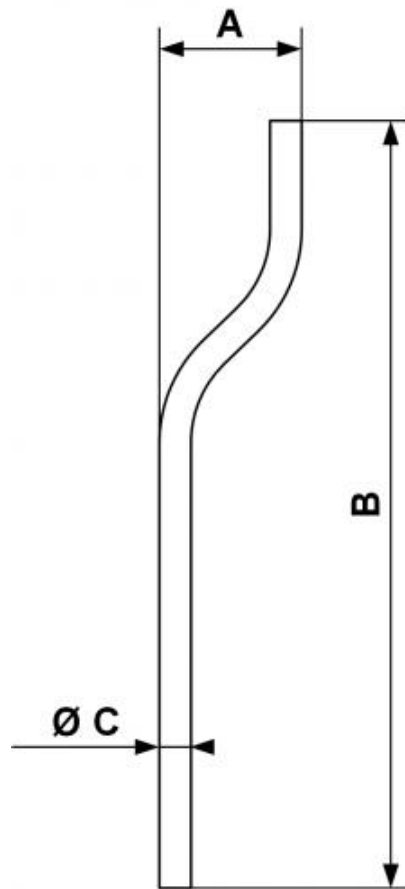

### Dimensions

Reference	A mm	B mm	C mm
<b>PPS LMCB16</b>	86	480	16
<b>PPS LMCB20</b>	90	487	20
<b>PPS LMCB25</b>	95	487	25