

Hose tail coupler

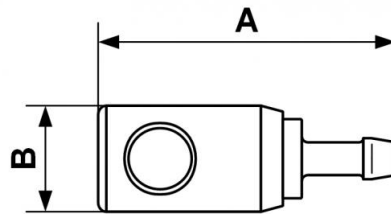

<p><u>For hose ID (mm)</u> 6</p>	<p><u>Profile</u> British</p>	<p><u>ID Passage</u> 6 mm</p>	<p><u>Construction</u> Treated steel Corrosion-proof treatment</p>
<p><u>Operating pressure</u> 0 to 12 bar</p>	<p><u>Technology</u> Push button</p>	<p><u>Temperature</u> -15°C to +70°C</p>	<p><u>Applications</u> Corrosive atmospheres</p>
<p><u>Flow rate at 6 bar</u> 750 l/min ($\Delta P = 0,6$ bar)</p>	<p><u>Highlight</u> Anti-static</p>		

Description	
Reference	For hose ID (mm)
BRM 061806	6
BRM 061808	8
BRM 061810	10
BRM 061813	13



Dimensions

Reference	A mm	B mm
BRM 061806	73	26
BRM 061808	73	26
BRM 061810	73	26
BRM 061813	78	26