

Manifold



Inlet BSPP female thread

G 3/4

Number of outlet

4

Outlet BSPP female thread

G 1/2

Operating pressure

2 to 12 bar

Temperature

- 20°C to + 80°C

Construction

Aluminium

Description

Reference	Inlet BSPP female thread	Number of outlet	Outlet BSPP female thread
MF 104S4	G 3/4	4	G 1/2
MF 104S6	G 3/4	6	G 1/2

Reference	Inlet BSPP female thread	Number of outlet	Outlet BSPP female thread
MF 104S8	G 3/4	8	G 1/2
MF 104S10	G 3/4	10	G 1/2

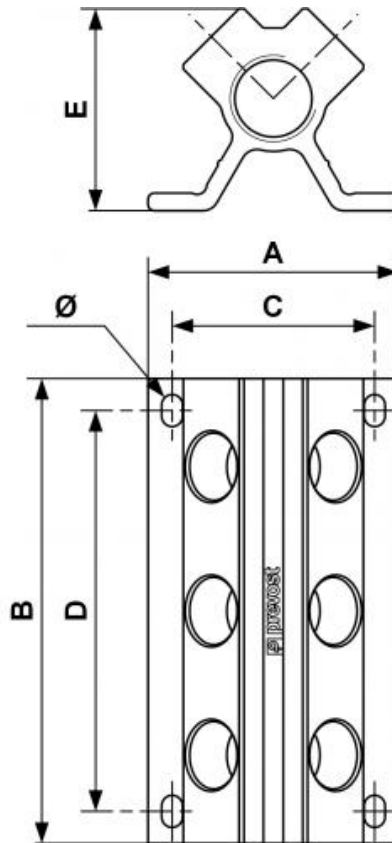

Dimensions

Reference	A mm	B mm	C mm	D mm	E mm
MF 104S4	78	100	63	80	6.5
MF 104S6	78	145	63	125	6.5
MF 104S8	78	190	63	170	6.5
MF 104S10	78	235	63	215	6.5