

Swivelling male tee piece with parallel male thread centre - RIT CG



BSPB male thread

G 1/8

For tube OD (mm)

4

Operating pressure

0 to 16 bar

Temperature

0°C to +120°C

Construction

Stainless steel AISI 316

Description

Reference	BSPB male thread	For tube OD (mm)
RIT CG0400	G 1/8	4
RIT CG0600	G 1/8	6
RIT CG0601	G 1/4	6
RIT CG0800	G 1/8	8
RIT CG0801	G 1/4	8
RIT CG0802	G 3/8	8

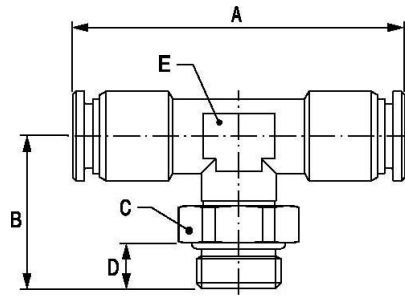

Dimensions

Reference	A mm	B mm	C mm	D mm
RIT CG0400	35	16	13	5
RIT CG0600	37	17	13	5
RIT CG0601	39	20	17	7
RIT CG0800	40	18	13	5
RIT CG0801	43	21	17	7
RIT CG0802	45	22	19	8