

## Micro tee with parallel male side leg - RCT AG



### Metric male thread

M3

### For tube OD (mm)

4

### Operating pressure

0 to 10 bar

### Temperature

0°C to + 60°C

### Construction

Polymer and nickel-plated  
brass

## Description

Reference	Metric male thread	For tube OD (mm)
<b>RLT AG04M3</b>	M3	4
<b>RLT AG04M5</b>	M5	4
<b>RLT AG06M5</b>	M5	6

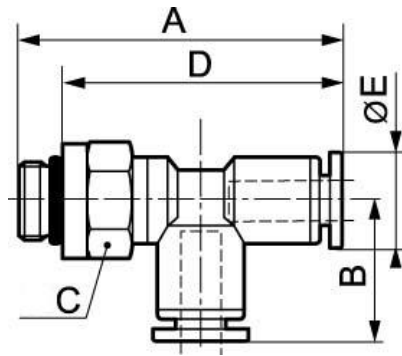

### Dimensions

Reference	A mm	B mm	C mm	D mm	E mm
<b>RLT AG04M3</b>	29.5	13.8	8	26.5	8.5
<b>RLT AG04M5</b>	30	13.8	8	26.5	8.5
<b>RLT AG06M5</b>	34.7	13.5	10	31.2	10.5