

Micro tee with parallel male side leg - RCT AG



BSPB male thread

G 1/8

For tube OD (mm)

4

Operating pressure

0 to 10 bar

Temperature

0°C to + 60°C

Construction

Polymer and nickel-plated
brass

Description

Reference	BSPB male thread	For tube OD (mm)
RLT AG0400	G 1/8	4
RLT AG0600	G 1/8	6

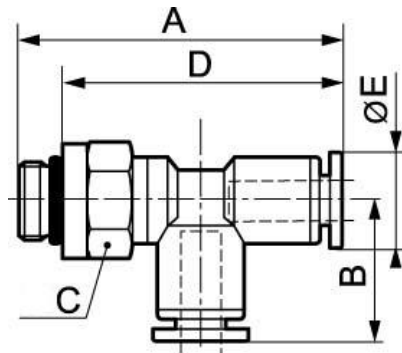

Dimensions

Reference	A mm	B mm	C mm	D mm	E mm
RLT AG0400	33	13.8	10	25.5	8.5
RLT AG0600	39.2	17.5	10	31.7	10.5