

Micro union for equal tubes - RCU ET



For tube OD (mm)

4

Operating pressure

0 to 10 bar

Temperature

0°C to + 60°C

Construction

Polymer and nickel-plated
brass

Description

Reference	For tube OD (mm)
RLU ET0404	4
RLU ET0606	6

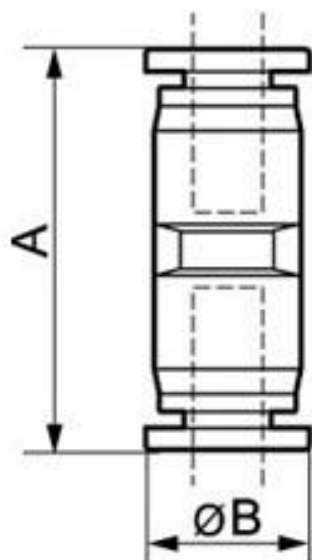

Dimensions		
Reference	A mm	B mm
RLU ET0404	23.4	8.5
RLU ET0606	28	10.5