

Micro equal union bulkhead fitting - RCU TT

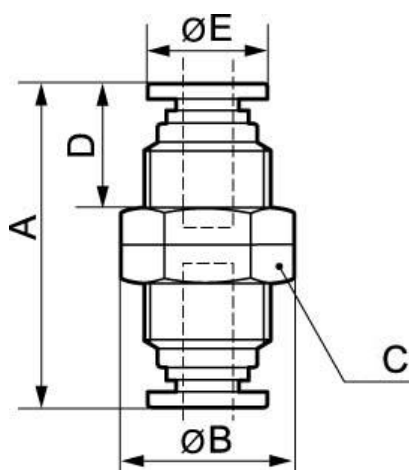

<u>Panel depth (mm)</u> 5,5	<u>Drill Ø (mm)</u> 13	<u>For tube OD (mm)</u> 4	<u>Operating pressure</u> 0 to 10 bar
<u>Temperature</u> 0°C to + 60°C	<u>Construction</u> Polymer and nickel-plated brass		

Description			
Reference	Panel depth (mm)	Drill Ø (mm)	For tube OD (mm)
RLU TT0404	5,5	13	4
RLU TT0606	5,5	15	6



Dimensions

Reference	A mm	B mm	C mm	D mm	E mm
RLU TT0404	26.2	14	12	9.5	9.5
RLU TT0606	26.2	16.5	14	9.5	10.7