

Micro equal Y piece - RLY ET



For tube OD (mm)

6

Operating pressure

0 to 10 bar

Temperature

0°C to + 60°C

Construction

Polymer and nickel-plated
brass

Description

Reference

For tube OD (mm)

RLY ET0606

6

RLY ET0404

4

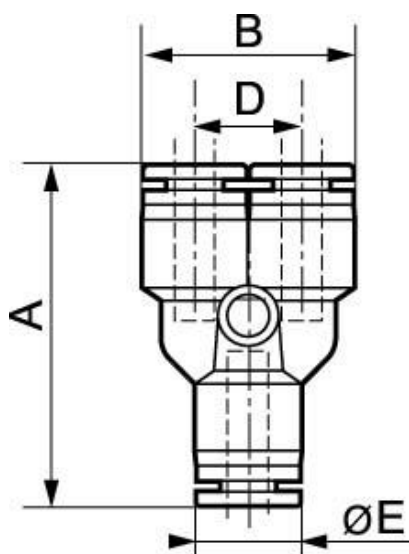

Dimensions

Reference

RLY ET0606

RLY ET0404