

Tapered male thread - Hose tail - JFT



BSPT male thread

R 1/8

For hose ID (mm)

4

Technology

Straight through path

Operating pressure

0 to 15 bar

Description

| Reference | BSPT male thread | For hose ID (mm) |
|-----------------|------------------|------------------|
| JFT 1804 | R 1/8 | 4 |
| JFT 1806 | R 1/8 | 6 |
| JFT 1807 | R 1/8 | 7 |
| JFT 1808 | R 1/8 | 8 |
| JFT 1404 | R 1/4 | 4 |
| JFT 1406 | R 1/4 | 6 |
| JFT 1407 | R 1/4 | 7 |
| JFT 1408 | R 1/4 | 8 |
| JFT 1409 | R 1/4 | 9 |
| JFT 1410 | R 1/4 | 10 |
| JFT 1412 | R 1/4 | 12 |

| Reference | BSPT male thread | For hose ID (mm) |
|-----------|------------------|------------------|
| JFT 3808 | R 3/8 | 8 |
| JFT 3809 | R 3/8 | 9 |
| JFT 3810 | R 3/8 | 10 |
| JFT 3812 | R 3/8 | 12 |
| JFT 3814 | R 3/8 | 14 |
| JFT 3816 | R 3/8 | 16 |
| JFT 1212 | R 1/2 | 12 |
| JFT 1214 | R 1/2 | 14 |
| JFT 1216 | R 1/2 | 16 |
| JFT 1219 | R 1/2 | 19 |

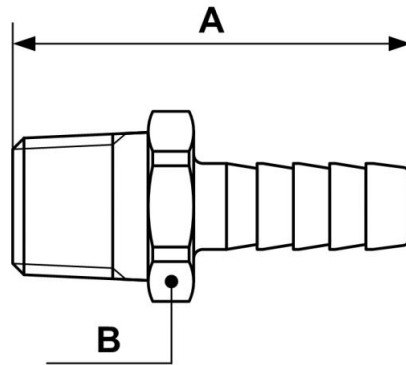

Dimensions

| Reference | A mm | B mm |
|-----------|------|------|
| JFT 1804 | 40 | 14 |
| JFT 1806 | 40 | 14 |
| JFT 1807 | 40 | 14 |
| JFT 1808 | 40 | 14 |
| JFT 1404 | 44 | 14 |
| JFT 1406 | 44 | 14 |
| JFT 1407 | 44 | 14 |
| JFT 1408 | 44 | 14 |
| JFT 1409 | 44 | 14 |
| JFT 1410 | 44 | 14 |
| JFT 1412 | 44 | 14 |
| JFT 3808 | 44 | 19 |
| JFT 3809 | 44 | 19 |
| JFT 3810 | 44 | 19 |
| JFT 3812 | 44 | 19 |
| JFT 3814 | 44 | 19 |

| Reference | A mm | B mm |
|-----------------|------|------|
| JFT 3816 | 44 | 19 |
| JFT 1212 | 49 | 24 |
| JFT 1214 | 49 | 24 |
| JFT 1216 | 49 | 24 |
| JFT 1219 | 49 | 24 |