

## Parallel male thread - Hose tail - 1 barb - JFT ZS



### BSPB male thread

G 1/8

### For hose ID (mm)

4

### Technology

Straight through path

### Operating pressure

0 to 15 bar

## Description

Reference	BSPB male thread	For hose ID (mm)
JFT 1804ZS	G 1/8	4
JFT 1806ZS	G 1/8	6
JFT 1406ZS	G 1/4	6
JFT 1408ZS	G 1/4	8
JFT 1409ZS	G 1/4	9
JFT 1410ZS	G 1/4	10
JFT 3808ZS	G 3/8	8
JFT 3810ZS	G 3/8	10
JFT 3813ZS	G 3/8	13
JFT 3816ZS	G 3/8	16
JFT 1208ZS	G 1/2	8

Reference	BSPB male thread	For hose ID (mm)
JFT 1209ZS	G 1/2	9
JFT 1210ZS	G 1/2	10
JFT 1213ZS	G 1/2	13
JFT 1216ZS	G 1/2	16
JFT 3416ZS	G 3/4	16

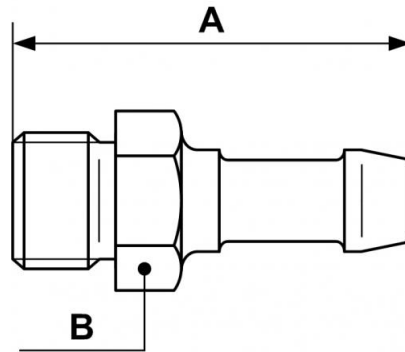

### Dimensions

Reference	A mm	B mm
JFT 1804ZS	43	14
JFT 1806ZS	43	14
JFT 1406ZS	46	17
JFT 1408ZS	46	17
JFT 1409ZS	46	17
JFT 1410ZS	46	17
JFT 3808ZS	47	19
JFT 3810ZS	47	19
JFT 3813ZS	52	19
JFT 3816ZS	52	23
JFT 1208ZS	53	23
JFT 1209ZS	53	23
JFT 1210ZS	53	23
JFT 1213ZS	53	23
JFT 1216ZS	54	23
JFT 3416ZS	58	29