

Non-return check valve



BSPP female thread

G 3/4

Max operating pressure (bar)

25

Temperature (°C)

-20 to +100

Construction

Brass body

Highlight

Network safety

Description

| Reference | BSPP female thread | Max operating pressure (bar) | Temperature (°C) |
|---------------|--------------------|------------------------------|------------------|
| A24 34 | G 3/4 | 25 | -20 to +100 |

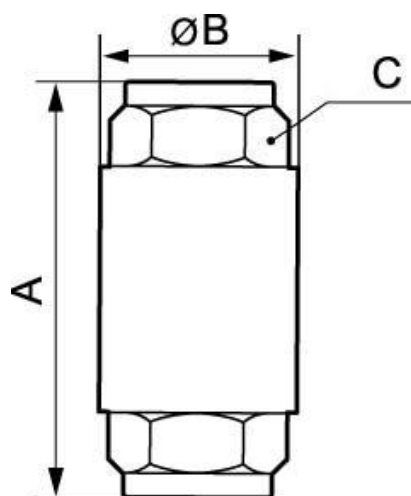

Dimensions

| Reference | A mm | B mm | C mm |
|---------------|------|------|------|
| A24 34 | 63.5 | 42 | 31 |