

Quick exhaust safety valve - A25



BSPP female thread

G 1/8

Max operating pressure (bar)

10

Temperature (°C)

-18 to +70

Construction

Brass body

Highlight

Network safety

Description

Reference	BSPP female thread	Max operating pressure (bar)	Temperature (°C)
A25 18	G 1/8	10	-18 to +70
A25 14	G 1/4	10	-18 to +70
A25 38	G 3/8	10	-18 to +70
A25 12	G 1/2	10	-18 to +70
A25 34	G 3/4	10	-18 to +70

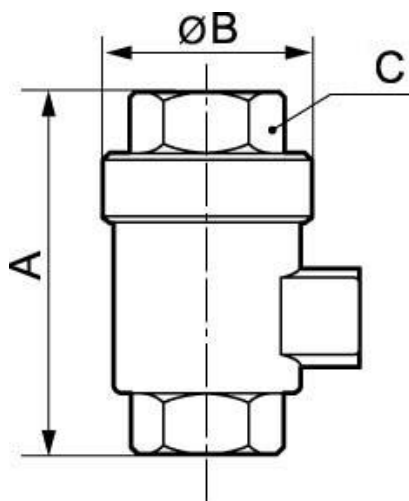

Dimensions

Reference	A mm	B mm	C mm
A25 18	42	28	14
A25 14	55	33	19
A25 38	61	38	22
A25 12	73	43	26
A25 34	90	49	32