

## Mini type (electrogalvanised steel)



<u>Ø min./max. (mm)</u>	<u>Tightening screw (Nm)</u>	<u>Band width (mm)</u>	<u>Packaging (Cardboard box)</u>
6 - 8	1.5	9	100
<u>Construction</u>			
Treated zinc-plated steel			

Description				
Reference	Ø min./max. (mm)	Tightening screw (Nm)	Band width (mm)	Packaging (Cardboard box)
<b>PBM 8</b>	6 - 8	1.5	9	100
<b>PBM 9</b>	7 - 9	1.5	9	100
<b>PBM 10</b>	8 - 10	1.5	9	100
<b>PBM 11</b>	9 - 11	1.5	9	100
<b>PBM 12</b>	9 - 12	1.5	9	100

Reference	Ø min./max. (mm)	Tightening screw (Nm)	Band width (mm)	Packaging (Cardboard box)
<b>PBM 13</b>	10 - 13	1.5	9	100
<b>PBM 14</b>	11 - 14	1.5	9	100
<b>PBM 15</b>	12 - 15	1.5	9	100
<b>PBM 16</b>	13 - 16	1.5	9	100
<b>PBM 17</b>	14 - 17	1.5	9	100

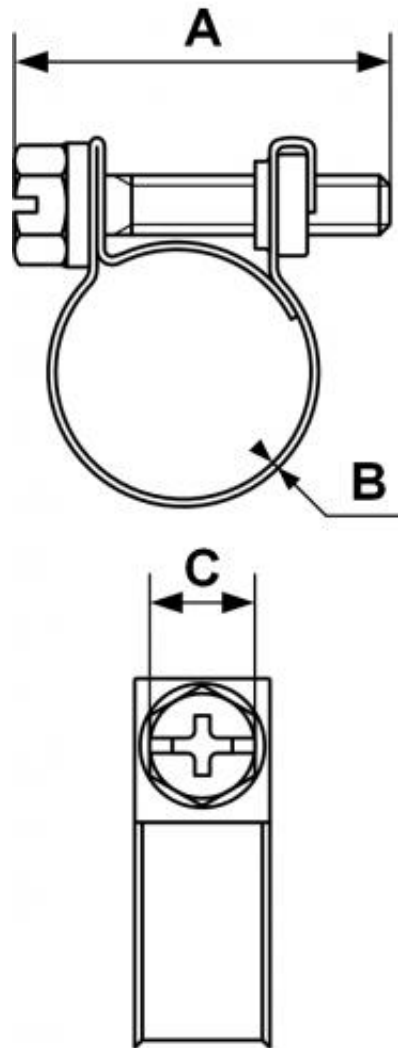

### Dimensions

Reference	A mm	B mm
<b>PBM 8</b>	0.709	0.02
<b>PBM 9</b>	0.709	0.02
<b>PBM 10</b>	0.709	0.02
<b>PBM 11</b>	0.827	0.02
<b>PBM 12</b>	0.827	0.02
<b>PBM 13</b>	0.827	0.02

Reference	A mm	B mm
<b>PBM 14</b>	0.827	0.02
<b>PBM 15</b>	0.984	0.02
<b>PBM 16</b>	0.984	0.02
<b>PBM 17</b>	0.984	0.02