

## Female thread coupler



### ID Passage (mm)

6

### BSPP female thread

G 1/4

### Max operating pressure

16 bar

### Temperature

+15°C to +200°C

### Construction

Brass body

### Applications

Cooling circuits, cleaning, rinsing, food processing industry

## Description

Reference	ID Passage (mm)	BSPP female thread
<b>PREOL 061101</b>	6	G 1/4
<b>PREOL 091102</b>	9	G 3/8
<b>PREOL 121103</b>	12	G 1/2
<b>PREOL 161104</b>	16	G 3/4

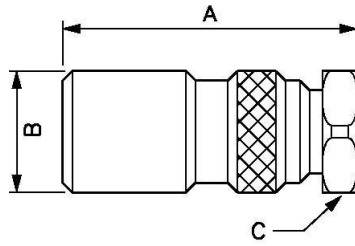

### Dimensions

Reference	A mm	B mm	C mm
<b>PREOL 061101</b>	46	19	17
<b>PREOL 091102</b>	53	25	22
<b>PREOL 121103</b>	67	31	27
<b>PREOL 161104</b>	91	38	35