

Hose tail coupler - Stainless Steel



<p><u>For hose ID (mm)</u> 6</p>	<p><u>Technology</u> Push button</p>	<p><u>Operating pressure</u> 0 to 12 bar</p>	<p><u>Flow rate at 6 bar</u> 800 l/min ($\Delta P = 0,6$ bar)</p>
<p><u>ID Passage</u> 6 mm</p>	<p><u>Temperature</u> -15°C to +70°C</p>	<p><u>Construction</u> Composite body Stainless steel valve</p>	<p><u>Applications</u> Corrosive atmospheres</p>
<p><u>Highlight</u> Non scratch</p>			

Description	
Reference	For hose ID (mm)
PROXI 061806	6

Reference	For hose ID (mm)
PROXI 061808	8
PROXI 061810	10

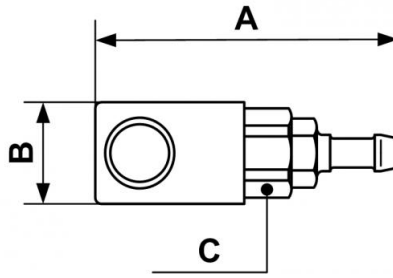

Dimensions

Reference	A mm	B mm	C mm
PROXI 061806	78	28	23
PROXI 061808	78	28	23
PROXI 061810	78	28	23