

## Tapered male thread s/steel adaptor - Stainless Steel



**BSPT male thread**

R 1/4

**Technology**

Push button

**Operating pressure**

0 to 12 bar

**Flow rate at 6 bar**

800 l/min ( $\Delta P = 0,6$  bar)

**ID Passage**

6 mm

**Temperature**

-15°C to +70°C

**Construction**

Composite body Stainless steel valve

**Applications**

Corrosive atmospheres

**Highlight**

Non scratch

### Description

Reference

BSPT male thread

**PROXI 066151**

R 1/4

**PROXI 066152**

R 3/8

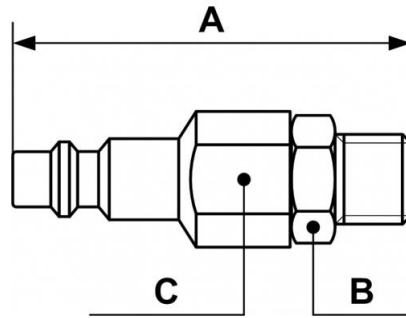

### Dimensions

Reference	A mm	B mm	C mm
<b>PROXI 066151</b>	65	17	17
<b>PROXI 066152</b>	65	17	20