

Hose tail adaptor - Stainless Steel

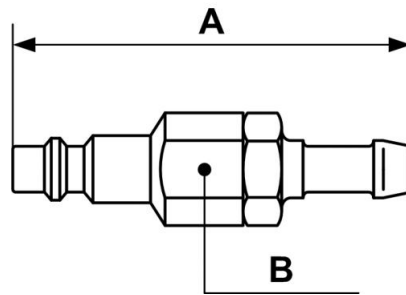

<p><u>For hose ID (mm)</u></p> <p>6</p>	<p><u>Technology</u></p> <p>Push button</p>	<p><u>Operating pressure</u></p> <p>0 to 12 bar</p>	<p><u>Flow rate at 6 bar</u></p> <p>800 l/min ($\Delta P = 0,6$ bar)</p>
<p><u>ID Passage</u></p> <p>6 mm</p>	<p><u>Temperature</u></p> <p>-15°C to +70°C</p>	<p><u>Construction</u></p> <p>Composite body Stainless steel valve</p>	<p><u>Applications</u></p> <p>Corrosive atmospheres</p>
<p><u>Highlight</u></p> <p>Non scratch</p>			

Description	
Reference	For hose ID (mm)
PROXI 066806	6
PROXI 066808	8
PROXI 066810	10



Dimensions

Reference	A mm	B mm
PROXI 066806	69	17
PROXI 066808	69	17
PROXI 066810	69	17