

PVR 3UL - PVC Female thread 3-piece brass union

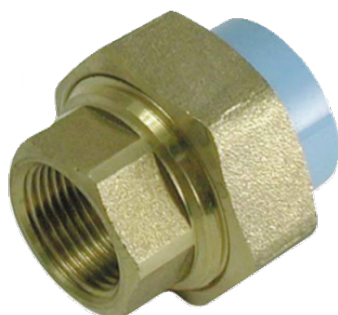

<u>For pipe OD (mm)</u> 20	<u>BSPP female thread</u> G 1/2	<u>Max operating pressure</u> 13 bar at 23°C 7 bar at 50°C	<u>Vacuum capability</u> -0.98 bar (vacuum 98%)
<u>Temperature</u> -20°C to +50°C	<u>Construction</u> Pipe and fittings: PVC	<u>Meets standards</u> PED REACH	

Description		
Reference	For pipe OD (mm)	BSPP female thread
PVR 3UL2012	20	G 1/2
PVR 3UL2527	25	G 3/4
PVR 3UL3234	32	G 1
PVR 3UL4042	40	G 1 1/4
PVR 3UL5049	50	G 1 1/2

Reference	For pipe OD (mm)	BSPP female thread
PVR 3UL6360	63	G 2

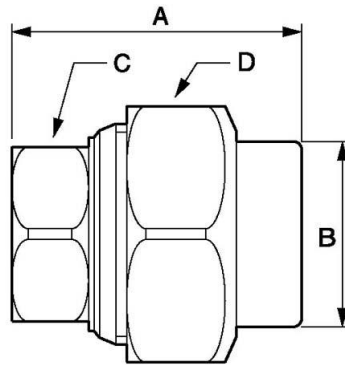

Dimensions

Reference	A mm	B mm	C mm	D mm
PVR 3UL2012	43	29	25	44
PVR 3UL2527	49.5	34	32	47
PVR 3UL3234	53	41.5	38	55
PVR 3UL4042	61	51.5	47	65
PVR 3UL5049	69	59	54	72
PVR 3UL6360	80	74	67	89