

Equal union - RB3



For tube Ø (mm)

6 x 4

Max operating pressure

15 bar

Temperature

-20°C to +80°C

Construction

Nickel-plated brass

Description

Reference	For tube Ø (mm)
RB3 6	6 x 4
RB3 8	8 x 6
RB3 10	10 x 8
RB3 12	12 x 10

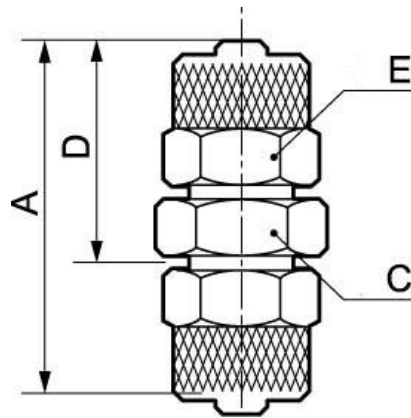

Dimensions				
Reference	A mm	C mm	D mm	E mm
RB3 6	33	12	19	12
RB3 8	30	12	27.5	12
RB3 10	37	14	21.5	16
RB3 12	42	17	19	19