

90° tapered male elbow - RB5



BSPT male thread

R 1/8

For tube Ø (mm)

6 x 4

Max operating pressure

15 bar

Temperature

-20°C to +80°C

Construction

Nickel-plated brass

Description

Reference	BSPT male thread	For tube Ø (mm)
RB5 618	R 1/8	6 x 4
RB5 614	R 1/4	6 x 4
RB5 818	R 1/8	8 x 6
RB5 814	R 1/4	8 x 6
RB5 838	R 3/8	8 x 6

Reference	BSPT male thread	For tube Ø (mm)
RB5 1014	R 1/4	10 x 8
RB5 1038	R 3/8	10 x 8
RB5 1238	R 3/8	12 x 10

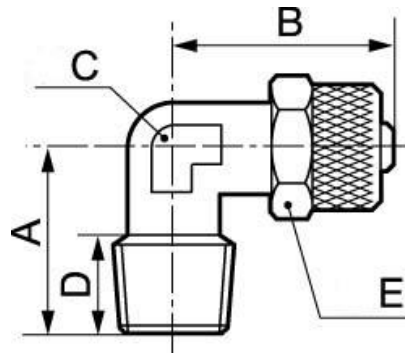

Dimensions

Reference	A mm	B mm	C mm	D mm	E mm
RB5 618	17	22	9	7	12
RB5 614	20	22	9	10	12
RB5 818	18	23	12	8	14
RB5 814	20	22	12	10	14
RB5 838	21	21	9	12	16
RB5 1014	20.5	25	12	10	16
RB5 1038	22	23	11	12	14
RB5 1238	24	31	17	12	19