

Nut - RO E



For tube OD (mm)

4

Max operating pressure

60 bar

Temperature

-40°C to +240°C

Construction

Nickel-plated brass

Description

Reference	For tube OD (mm)
RO E4	4
RO E6	6
RO E8	8
RO E10	10
RO E12	12

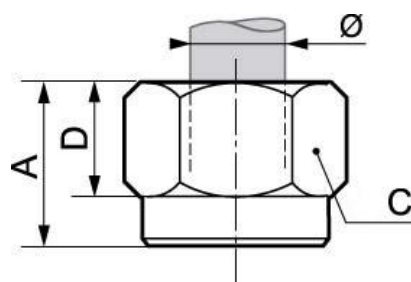

Dimensions

Reference	A mm	C mm	D mm
RO E4	11	10	8
RO E6	11.5	12	9
RO E8	13	14	10
RO E10	15.5	19	14
RO E12	15.5	22	14