

90° Tapered male thread elbow - RO5



BSPT male thread

R 1/8

For tube OD (mm)

4

Max operating pressure

60 bar

Temperature

-40°C to +240°C

Construction

Nickel-plated brass

Description

Reference	BSPT male thread	For tube OD (mm)
RO5 418	R 1/8	4
RO5 618	R 1/8	6
RO5 614	R 1/4	6
RO5 818	R 1/8	8
RO5 814	R 1/4	8
RO5 838	R 3/8	8

Reference	BSPT male thread	For tube OD (mm)
RO5 1014	R 1/4	10
RO5 1038	R 3/8	10
RO5 1238	R 3/8	12
RO5 1212	R 1/2	12

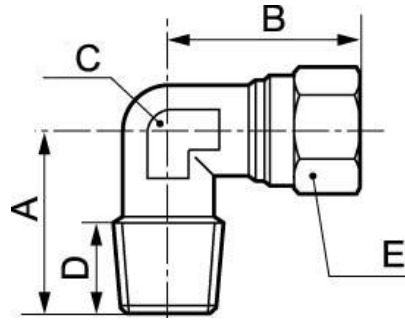

Dimensions

Reference	A mm	B mm	C mm	D mm	E mm
RO5 418	16	21.5	9	8	10
RO5 618	16	22	9	8	12
RO5 614	20	23.5	11	11	12
RO5 818	17	24	11	8	14
RO5 814	20	24	11	11	14
RO5 838	23.5	27	13	12	14
RO5 1014	22.5	32	13	11	19
RO5 1038	23.5	32	13	12	19
RO5 1238	24	33.5	15	11.5	22
RO5 1212	30	38	20	13	22