

## Bulkhead coupler



### BSPP male thread

G 3/4

### Drill Ø (mm)

28

### Panel depth (mm)

20

### Operating pressure

0 to 10 bar

### Flow rate

24 l/min ( $\Delta P = 0,3$  bar with shutter), 33,5 l/min ( $\Delta P = 0,3$  bar without shutter)

### ID Passage

9 mm

### Temperature

-15°C to +60°C

### Construction

Brass body

## Description

Reference	BSPP male thread	Drill Ø (mm)	Panel depth (mm)
<b>ELS 092154</b>	G 3/4	28	20

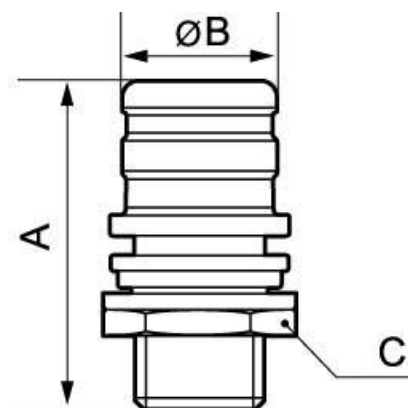

### Dimensions

Reference	A mm	B mm	C mm
<b>ELS 092154</b>	59	30	32