

Push-on straight plug for self-locking hose



For hose ID (mm)

10

Max operating pressure

10 bar

Flow rate

30 l/min ($\Delta P = 0,5\text{bar}$)

ID Passage

8 mm

Temperature

-15°C to +90°C

Construction

Body: nickel-plated brass

Description

Reference

For hose ID (mm)

CPI 086810CN

10

CPI 086813CN

13

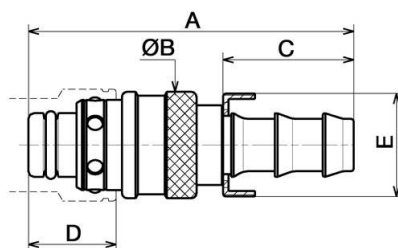

Dimensions

Reference	A mm	B mm	C mm	D mm	E mm
CPI 086810CN	61	20	24.5	16.4	19.4
CPI 086813CN	67	20	29	16.4	23.4