

Straight plug for hose



For hose ID (mm)

13

Max operating pressure

10 bar

Flow rate

85 l/min ($\Delta P = 0,5\text{bar}$)

ID Passage

12 mm

Temperature

-15°C to +90°C

Construction

Body: nickel-plated brass

Description

| Reference | For hose ID (mm) |
|-------------------|------------------|
| CPI 126813 | 13 |
| CPI 126816 | 16 |

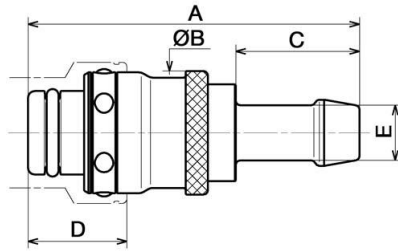

Dimensions

| Reference | A mm | B mm | C mm | D mm | E mm |
|-------------------|------|------|------|------|------|
| CPI 126813 | 75 | 28 | 28 | 22.4 | 12.5 |
| CPI 126816 | 75 | 28 | 28 | 22.4 | 15.5 |