

## Straight socket parallel female thread



BSPF female thread

G 1/8

Max operating pressure

10 bar

Flow rate

30 l/min ( $\Delta P = 0,5\text{bar}$ )

ID Passage

8 mm

Temperature

-15°C to +90°C

Construction

Body: nickel-plated brass

### Description

Reference	BSPF female thread
<b>CPI 081100</b>	G 1/8
<b>CPI 081101</b>	G 1/4

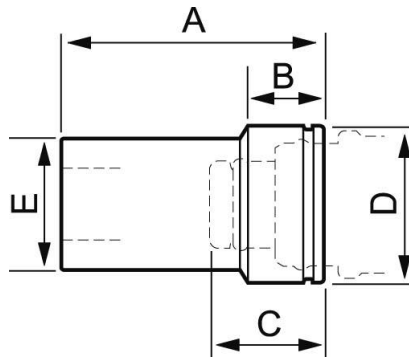

### Dimensions

Reference	A mm	B mm	C mm	D mm	E mm
<b>CPI 081100</b>	35	11	16.4	21	17.5
<b>CPI 081101</b>	37	10	16.4	21	17.5