

Parallel female thread coupler



BSPP female thread

G 1/4

Technology

"One push" safety system
(avoids hose whip)

Operating pressure

2 to 12 bar

Flow rate at 6 bar

1 820 l/min ($\Delta P = 0,6$ bar)

ID Passage

7,4 mm

Temperature

-15°C to +70°C

Construction

Composite body

Highlight

Anti-static Non scratch

Description

Reference

BSPP female thread

ESI 071101

G 1/4

ESI 071102

G 3/8

ESI 071103

G 1/2

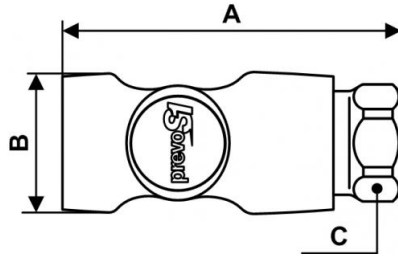

Dimensions

Reference	A mm	B mm	C mm
ESI 071101	73.3	32.25	23
ESI 071102	73.3	32.25	23
ESI 071103	80.3	32.25	26