

Bulkhead coupler



BSPP female thread

G 1/2

Drill Ø (mm)

27

Panel depth (mm)

11

Technology

"One push" safety system
(avoids hose whip)

Operating pressure

2 to 12 bar

Flow rate at 6 bar

1 820 l/min ($\Delta P = 0,6$ bar)

ID Passage

7,4 mm

Temperature

-15°C to +70°C

Construction

Composite body

Highlight

Anti-static Non scratch

Description

Reference	BSPP female thread	Drill Ø (mm)	Panel depth (mm)
ESI 072103	G 1/2	27	11

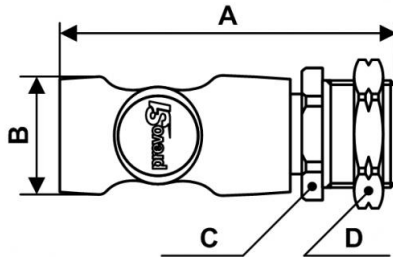

Dimensions

Reference	A mm	B mm	C mm	D mm
ESI 072103	87.8	32.25	29	32