

Plug-in straight reducer - RPR PT



For tube OD (mm)

4

Fitting ID (mm)

5

Operating pressure

0 to 10 bar

Temperature

0°C to + 60°C

Construction

Polymer and nickel-plated
brass

Description

Reference	For tube OD (mm)	Fitting ID (mm)
RPR PT0504	4	5
RPR PT0604	4	6
RPR PT0804	4	8
RPR PT0806	6	8

Reference	For tube OD (mm)	Fitting ID (mm)
RPR PT1006	6	10
RPR PT1008	8	10
RPR PT1208	8	12
RPR PT1210	10	12

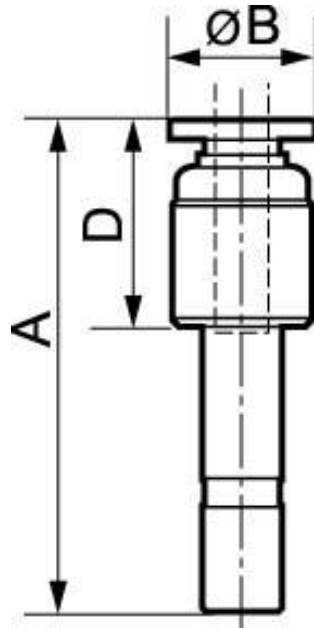

Dimensions

Reference	A mm	B mm	D mm
RPR PT0504	37	10	15.5
RPR PT0604	37	10	15.5
RPR PT0804	37	10	15.5
RPR PT0806	37.5	12.8	16
RPR PT1006	41	12.8	16
RPR PT1008	44	13.8	19
RPR PT1208	43	13.8	18
RPR PT1210	42.5	16.8	17.5