

Straight union for tubes - RPU ET



For tube OD (mm)

4

Operating pressure

0 to 10 bar

Temperature

0°C to + 60°C

Construction

Polymer and nickel-plated
brass

Description

Reference	For tube OD (mm)
RPU ET0404	4
RPU ET0505	5
RPU ET0606	6
RPU ET0808	8
RPU ET1010	10
RPU ET1212	12
RPU ET1414	14

Reference	For tube OD (mm)
RPU ET1616	16

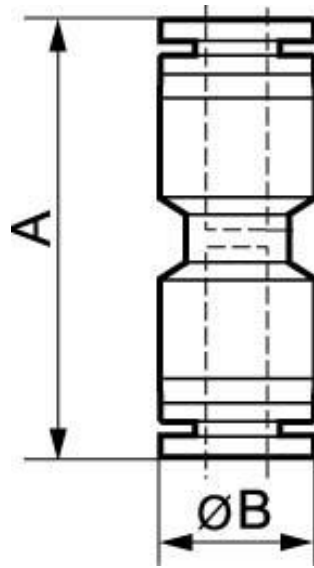

Dimensions

Reference	A mm	B mm
RPU ET0404	30	10
RPU ET0505	36.7	12.8
RPU ET0606	36.7	12.8
RPU ET0808	39	13.8
RPU ET1010	42.2	16.8
RPU ET1212	44.3	19.8
RPU ET1414	49.5	22.7
RPU ET1616	49.6	23.8