

## Parallel male regulator with adjusting screw - Cylinder supply - RPV IG



Metric male thread

M5

For tube OD (mm)

4

Operating pressure

0 to 10 bar

Temperature

0°C to + 60°C

Construction

Polymer and nickel-plated  
brass

### Description

Reference	Metric male thread	For tube OD (mm)
<b>RPV IG04M5</b>	M5	4
<b>RPV IG06M5</b>	M5	6

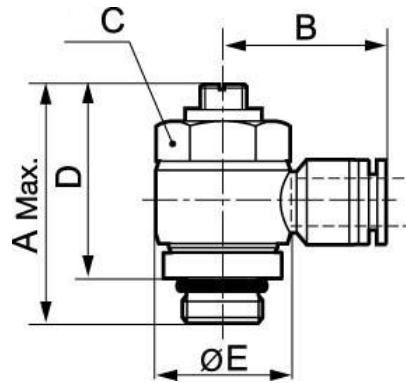

### Dimensions

Reference	A mm	B mm	C mm	D mm	E mm
<b>RPV IG04M5</b>	25	19.7	8	21	10
<b>RPV IG06M5</b>	25	22.5	8	21	10