

## Parallel female banjo fitting - RPB FG



### BSP female thread

G 1/8

### For tube OD (mm)

4

### Operating pressure

0 to 10 bar

### Temperature

0°C to + 60°C

### Construction

Polymer and nickel-plated  
brass

## Description

Reference	BSP female thread	For tube OD (mm)
<b>RPB FG0400</b>	G 1/8	4
<b>RPB FG0401</b>	G 1/4	4
<b>RPB FG0500</b>	G 1/8	5
<b>RPB FG0501</b>	G 1/4	5
<b>RPB FG0502</b>	G 3/8	5

Reference	BSPF female thread	For tube OD (mm)
<b>RPB FG0503</b>	G 1/2	5
<b>RPB FG0600</b>	G 1/8	6
<b>RPB FG0601</b>	G 1/4	6
<b>RPB FG0602</b>	G 3/8	6
<b>RPB FG0603</b>	G 1/2	6
<b>RPB FG0800</b>	G 1/8	8
<b>RPB FG0801</b>	G 1/4	8
<b>RPB FG0802</b>	G 3/8	8
<b>RPB FG0803</b>	G 1/2	8
<b>RPB FG1000</b>	G 1/8	10
<b>RPB FG1001</b>	G 1/4	10
<b>RPB FG1002</b>	G 3/8	10
<b>RPB FG1003</b>	G 1/2	10
<b>RPB FG1201</b>	G 1/4	12
<b>RPB FG1202</b>	G 3/8	12
<b>RPB FG1203</b>	G 1/2	12
<b>RPB FG1602</b>	G 3/8	16
<b>RPB FG1603</b>	G 1/2	16

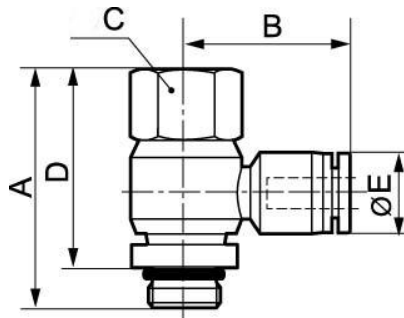

### Dimensions

Reference	A mm	B mm	C mm	D mm	E mm
RPB FG0400	30	23.5	12	24.5	10
RPB FG0401	32	24	17	26	10
RPB FG0500	30	23.5	12	24.5	12.8
RPB FG0501	32	25	17	26	12.8
RPB FG0502	39	26.5	19	32.5	12.8
RPB FG0503	42	29.5	24	34	12.8
RPB FG0600	30	23	12	24.5	12.8
RPB FG0601	32	25	17	26	12.8
RPB FG0602	39	26.5	19	32.5	12.8
RPB FG0603	42	29.8	24	34	12.8
RPB FG0800	30	25	12	24.5	13.8
RPB FG0801	32	27	17	26	13.8
RPB FG0802	39	29	19	32.5	13.8
RPB FG0803	42	30.3	24	34	13.8
RPB FG1000	30	29	12	24.5	16.8
RPB FG1001	32	33	17	26	16.8

Reference	A mm	B mm	C mm	D mm	E mm
<b>RPB FG1002</b>	39	32	19	32.5	16.8
<b>RPB FG1003</b>	42	34	24	34	16.8
<b>RPB FG1201</b>	32	31	17	26	19.8
<b>RPB FG1202</b>	39	34	19	32.5	19.8
<b>RPB FG1203</b>	42	36	24	34	19.8
<b>RPB FG1602</b>	39	34	19	32.5	23.8
<b>RPB FG1603</b>	42	36.3	24	34	23.8