

Thread stem adaptor



BSPB male thread

G 3/4

For hose ID (mm)

13

Operating pressure

0 to 10 bar

Flow rate

24 l/min ($\Delta P = 0,3$ bar with shutter), 33,5 l/min ($\Delta P = 0,3$ bar without shutter)

ID Passage

9 mm

Temperature

-15°C to +60°C

Construction

Chrome-plated brass body

Description

Reference	BSPB male thread	For hose ID (mm)
EFT 3413	G 3/4	13
EFT 3415	G 3/4	15
EFT 3419	G 3/4	19

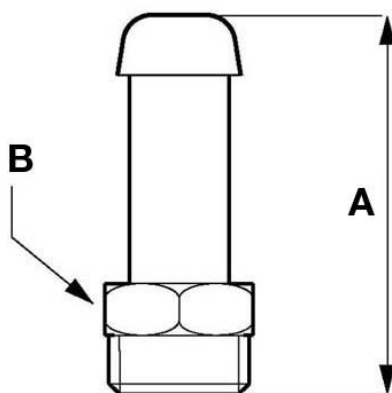

Dimensions

Reference	A mm	B mm
EFT 3413	41	27
EFT 3415	41	27
EFT 3419	41	27