

thread hydraulic High-Pressure coupler

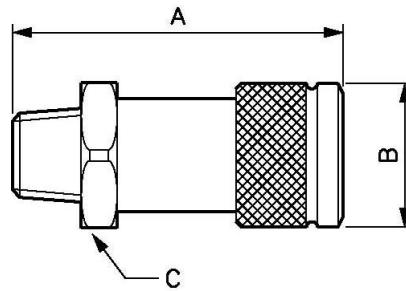

| | | | |
|--|---|---|---|
| <p><u>NPT male thread</u></p> <p>1/4</p> | <p><u>Nominal Ø (mm)</u></p> <p>6</p> | <p><u>Flow rate (nominal in l/min)</u></p> <p>5</p> | <p><u>Max operating pressure (bar)</u></p> <p>700</p> |
| <p><u>Profile</u></p> <p>Interchangeable</p> | <p><u>Technology</u></p> <p>Screw lock</p> | <p><u>Temperature</u></p> <p>-25°C to +100°C</p> | <p><u>Construction</u></p> <p>Body: steel</p> |
| <p><u>Applications</u></p> <p>Auto : cylinders, press extractors</p> | <p><u>Highlight</u></p> <p>Pressurised connection</p> | <p><u>Connection</u></p> <p>Manual screw thread</p> | |

| Description | | | | |
|-------------------|-----------------|----------------|------------------------------|------------------------------|
| Reference | NPT male thread | Nominal Ø (mm) | Flow rate (nominal in l/min) | Max operating pressure (bar) |
| HBC 061251 | 1/4 | 6 | 5 | 700 |
| HBC 101252 | 3/8 | 10 | 9 | 700 |



Dimensions

| Reference | A mm | B mm | C mm |
|-------------------|------|------|------|
| HBC 061251 | 60 | 30 | 21.5 |
| HBC 101252 | 71 | 35 | 23.5 |