

## Female thread coupler 135°



ID Passage (mm)

6

BSPP female thread

G 1/4

Max operating pressure

16 bar

Temperature

+15°C to +200°C

Construction

Brass body

Applications

Cooling circuits, cleaning, rinsing, food processing industry

### Description

| Reference             | ID Passage (mm) | BSPP female thread |
|-----------------------|-----------------|--------------------|
| <b>PREOL 061101RO</b> | 6               | G 1/4              |

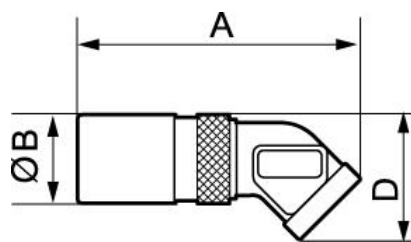

### Dimensions

| Reference             | A mm | B mm | D mm |
|-----------------------|------|------|------|
| <b>PREOL 061101RO</b> | 57.7 | 19   | 48.5 |