

## Tapered female thread coupler



**BSPF female thread**

G 3/8

**Technology**

Safety (avoid hose whip)

**Operating pressure**

2 to 16 bar

**Flow rate at 6 bar**

4120 l/min ( $\Delta P = 0,6$  bar)

**ID Passage**

11 mm

**Temperature**

-15°C to +70°C

**Construction**

Body : Stainless steel

**Highlight**

Anti-static

### Description

Reference	BSPF female thread
<b>CSM 111102</b>	G 3/8
<b>CSM 111103</b>	G 1/2
<b>CSM 111104</b>	G 3/4

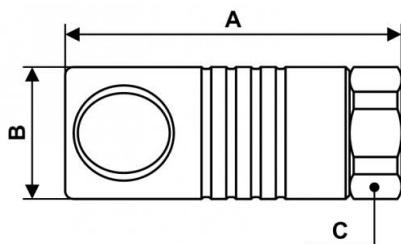

### Dimensions

Reference	A mm	B mm	C mm
<b>CSM 111102</b>	84	33	30
<b>CSM 111103</b>	87	33	30
<b>CSM 111104</b>	92	33	30